

CONNECTION - INSERT (SPACER)

PN 400 (PN 250)

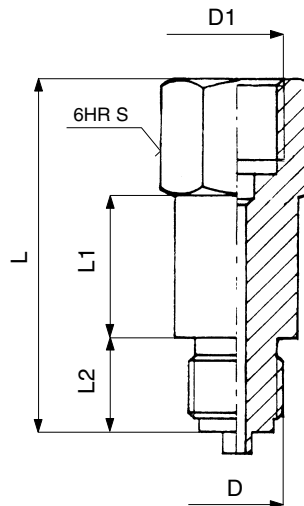

Connecting and construction dimensions

D	D1	L	L1	L2	S	kg	Order No.
1/2 NPT	1/2 NPT .3	75	30	20	27	0,23	81 1112
1/2 NPT	1/2 NPT .2	75	30	20	27	0,23	81 0114
1/2 NPT	1/2 NPT .5	75	30	20	27	0,23	81 0113
G 1/2	G 1/2 .3	75	30	20	27	0,23	81 0108
G 1/2	G 1/2 .2	75	30	20	27	0,23	81 0110
G 1/2	G 1/2 .5	75	30	20	27	0,23	81 0109

Use

It is used for connection of pressure gauge fittings to pressure devices at pressures up to 40 MPa. Use for: air, water, water steam and acid-free oils.

Maximum working		Material design
temperature [°C]	overpressure [MPa]	
120	25	brass .5
120	40	structural carbon steel .2
120	40	stainless aust. steel .3

Suitability of the material design in depending on working medium must be consulted with manufacturer.

Material

See the table.

Testing

Testing in accordance with ČSN 13 3060, or possibly DIN 3230.

Connection

Connecting and construction dimensions are given in the table.

Placing an order

Data necessary to place an order:

- nominal pressure (PN)
- working medium
- actual max. working temperature of medium [°C]
- actual max. working overpressure [MPa]